

# Smart Possibilities

Schedule switch on and off from the Smart Life app. Have schedules that start everyday at the same time or once a week. Anything.

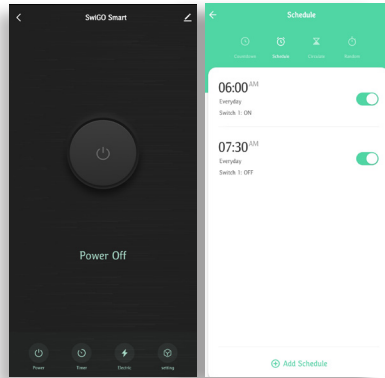

Monitor power consumption from the Smart Life app. Know which appliances are power consuming.

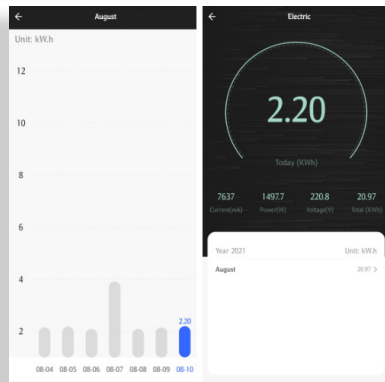

SwiGO Smart protects equipment from: Overload, Dry run, High Voltage, Low Voltage by allowing you to set an operation range on the Smart Life app.

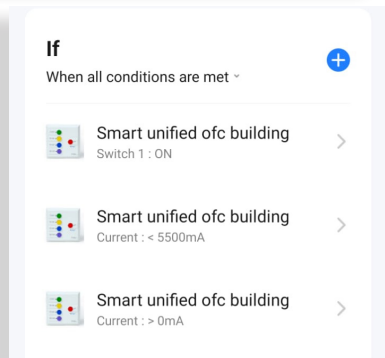

Scan for Smart Instructions setup Video and Instruction booklet

## Variants

SwiGO Smart comes with 4 variants. They have different pre-programmed physical switches but have all the same smart features.

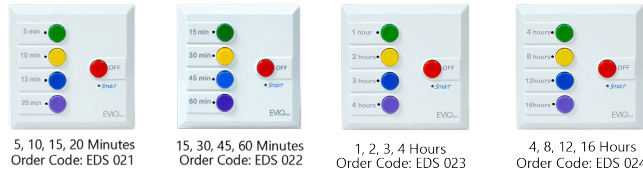

## Other Energy and Life Saving products

EVIQtech designs for ease of use. We make smart, safe and simple products that everybody in your home can use



Smart Pump Controller for 1 Phase Submersible

Smart Pump Controller for 3 Phase DOL

SwiGO tested as per IEC 60669-2 at CETL



**EVIQtech**  
Safe and smart electrical accessories

Made in India. Made by EVIQtech.

Email: info@eviqtech.com | Website: www.eviqtech.com  
Ph No. : +91 9840303287, +91 78457 21020

**SwiGO<sup>®</sup>**  
*Smart*

Switch and Go... It is okay to forget...

Design registered



## An Internet-Connected Smart Timer Switch

for Water Pumps, Water Heaters and other household products

Protect your appliances from Over-Current and Dry-run using SwiGO Smart!

Now withstands High Voltages upto 440V AC & With Float Switch output

**EVIQtech**  
Safe and smart electrical accessories

# SwiGO Smart simplifies daily home life

How often do you forget to switch off the Water Pump or the Water Heater on time? *SwiGO Smart* helps by switching on and off after a set time.

With *SwiGO Smart*, you can control and monitor your appliances from anywhere in the world. Just be connected to the Internet!



Use with Water Pumps directly up to 2HP. You don't have to go down even once! Use your smart phone!



Need your compound lighting or shop-banners to switch on and off at the right time?



A dependent parent living alone? Ease their lives and operate the essentials remotely. Or, teach them to press one single button.

SwiGO Smart can withstand High Voltages upto 440V AC (SwiGO will cut-off output above 290V AC) and not be damaged. Your investment is safe.

## Features

For simple physical operation, 4 buttons with pre-set times are available.

For scheduling and smart features, there are limitless options in the Smart Life app.

Measures Current and Voltage used. Set 'if', 'then' conditions from app to start and stop. Use 'if', 'and' conditions to protect from Over Current and Dry Runs

A physical LED indicator blinks for whichever time mode is active.

## Usage

1. Connect the device to your WiFi network via the Smart Life app on your phone.
2. After configuring the device, you can control the device from anywhere in the world. Indicator LED (4) blinks when smart functions are active
3. It can be operated physically by using any of the 4 time buttons(1). An indicator light blinks when active(3).
4. The stop button(2) immediately switches off.
5. 5V DC output cable for Safe Float Switch (not supplied) connection. Once the Float Switch detects tank full, SwiGO Smart switches off & the 4LEDs blink in sequence for 5 times



## Specifications

Description	Value
Rated Voltage	250V AC 50Hz
Maximum Operating Current	16AX/ 2HP/ 3KW
Max withstand Voltage	440V AC
Cut-Off Voltage	<190V && >290V AC
DC Output for float switch	5V DC
Mounting Method	Flush/Surface
Suitable Box	Indian - 2 module box
Conforms to standard	IS/ IEC 60669-2
Color	White
Warranty	1 Year
Product weight	140 grams
Product Dimensions	87 x 87 x 45 mm
Terminal size	2.5 mm <sup>2</sup> x 2

## Installation



1. Remove the front plate.
2. Take the L and N wire out of mounting box and wire it as shown, observing correct polarity.
3. Insert the wired *SwiGO Smart* into the mounting box.
4. Fix the mounting screw connecting the module and the box.
5. Fix the clip-on faceplate on the module snugly
6. 5V DC output cable: Connect float switch for safe operation (not provided). DO NOT CONNECT 230V AC to this cable. (Float Switch connection is optional, consider if you have a tank that gets full unpredictably).

### With Sump / Monobloc - Single Phase Pumps

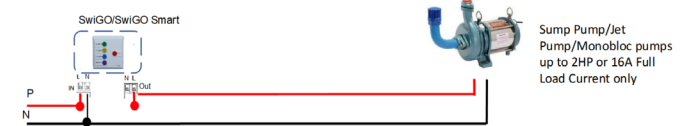

### Wiring Instructions for Single Phase Submersible Pumps (for pumps with a push button starter, EVIQtech Self Starter is additionally required)

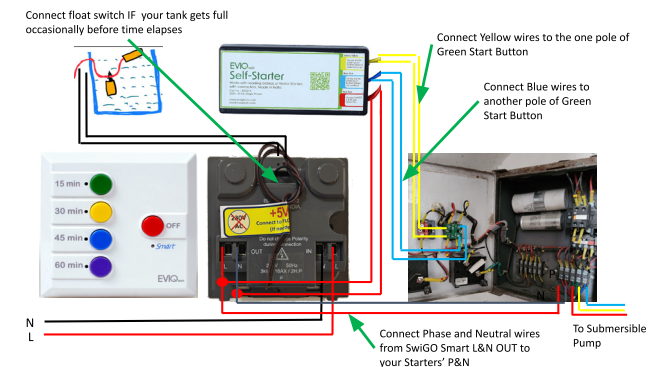

Scan for YouTube video help on installing SwiGO Smart with Single Phase Submersible Pumps